

TAURANGA BOYS COLLEGE TURF EVENTS

Event Health & Safety Plan.

The AIMS Games for 2021 start at Tauranga Boys Hockey Turf on Saturday the 4th of September when the Venue will be available for practice sessions, unless previously booked.

The Turf has been made available from Monday the 6th at 7.30pm until Friday the 10th at 10pm for this Tournament.

TURF:

The Turf will be inspected each Tournament day at 7am to ensure the Turf is clear and usable and the fencing, gates, dugout, goals, nets, etc will be checked for damage/defects that will need to be repaired so the Tournament can proceed safely.

Footwear brushes have been installed at the single gates at both ends of the Turf. This is to minimize the amount of grass/dirt being carried into the Turf area on footwear from the warm up area.

Appropriate footwear ***only*** is allowed onto the Turf area.

Food and Drink, except water, is not permitted on the Turf area.

RUBBISH:

Extra rubbish bins will be distributed around the areas that are being used for the Tournament. The bins will be emptied every morning prior to the Tournament starting as well as the area being cleared of rubbish on the ground.

TOILETS:

The changing sheds will be open and the toilets in them available to the teams using them.

Extra toilets (Portaloos) will be situated at the 15th Ave end of the Turf around the changing room area. These will be available to the Public and Players. They will be serviced as arranged by Tauranga Hockey Association.

CLEANING:

The changing sheds, and the toilets within the sheds, will be cleaned daily by Tauranga Boys College cleaners.

The consumables will be checked and re-stocked daily.

FIRST AID:

This is being organized by Tauranga Hockey Association. The Station will be located at the 15th Ave end of the Turf, in the warm up area, close to the Turf.

As a back up the Hockey Turf Office has a fridge/freezer in it containing ice and there is also a collapsible stretcher situated in there.

There is also a defibrillator on site and this is located in the "pigeon hole" area of the Staffroom.

PARKING:

As this Tournament is being held during School term time it will mean that Parking will be at a premium most of the time during the School day.

Please refer to the attached map for;

Team Van parking,

Officials parking.

Parking is also available in the Schools Devonport road Car park.

There is to be no parking in the School grounds areas off the Cameron road entrance.

There is also limited parking along Cameron road in front of the School.

Other areas where parking may be found are Devonport Rd and 13th Ave.

General:

The occurrence of any damage, breakage, incidents, repairs required, etc needs to be reported to the Facilities Co-Ordinator or the Property Manager as soon as possible.

CONTACTS:

The following personnel are the contacts for the duration of the Tournament:

Chris Thoroughgood-Facilities Co-Ordinator 0274 945 839

Available: 7.30-12.00 & 4-10.30pm, Mon, Thurs & Fri

Sat & Sun-variable hours.

Wayne Merritt-Property Manager 021 022 40598

Available: 7.30-3.00pm Weekdays

Chris Harris-Head Grounds-men 0273 255 325

Available: 7.30-4.00pm Weekdays

EVACUATION & EMERGENCY PLAN

Please see attached procedures.

Evacuation Plan

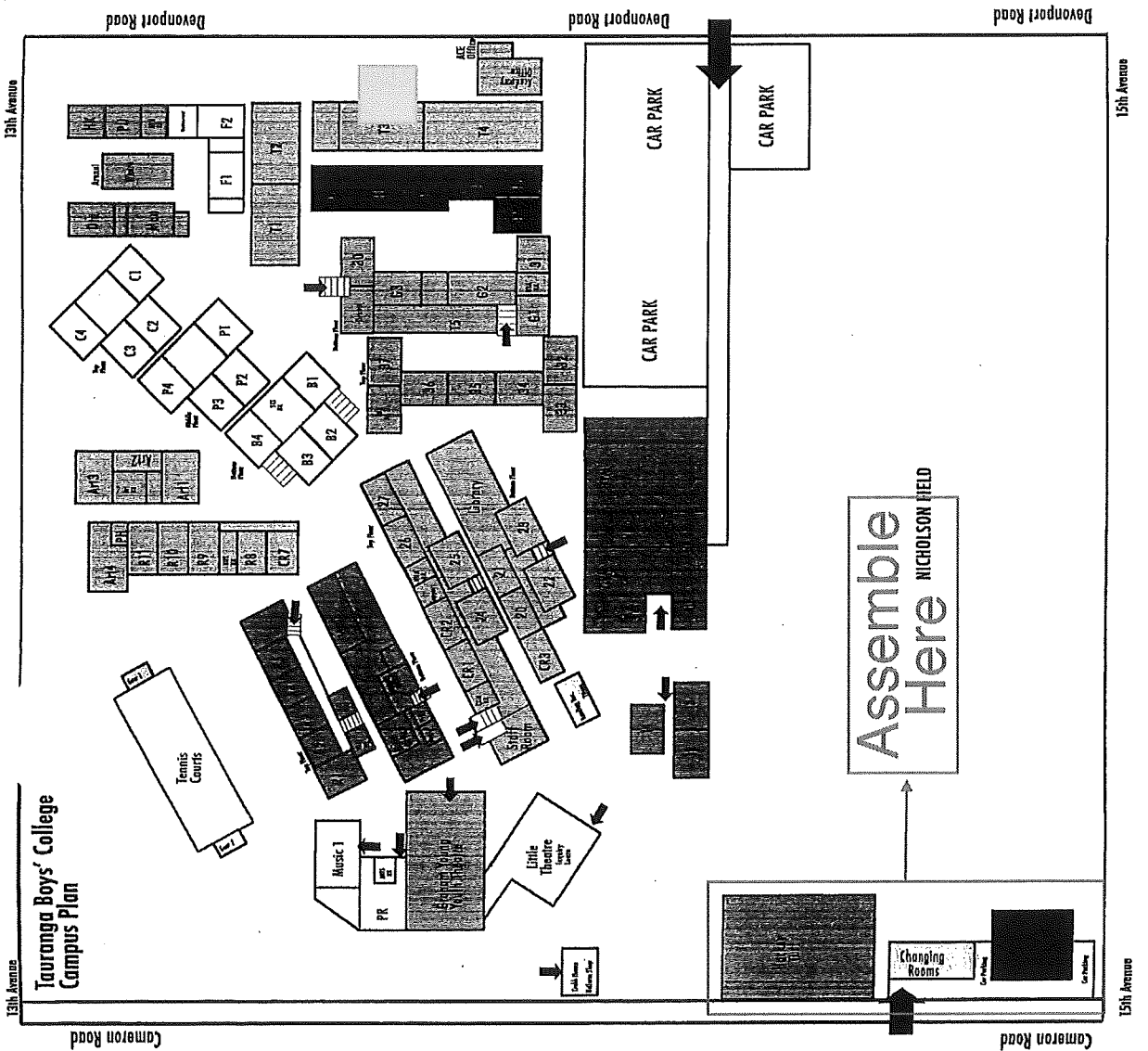
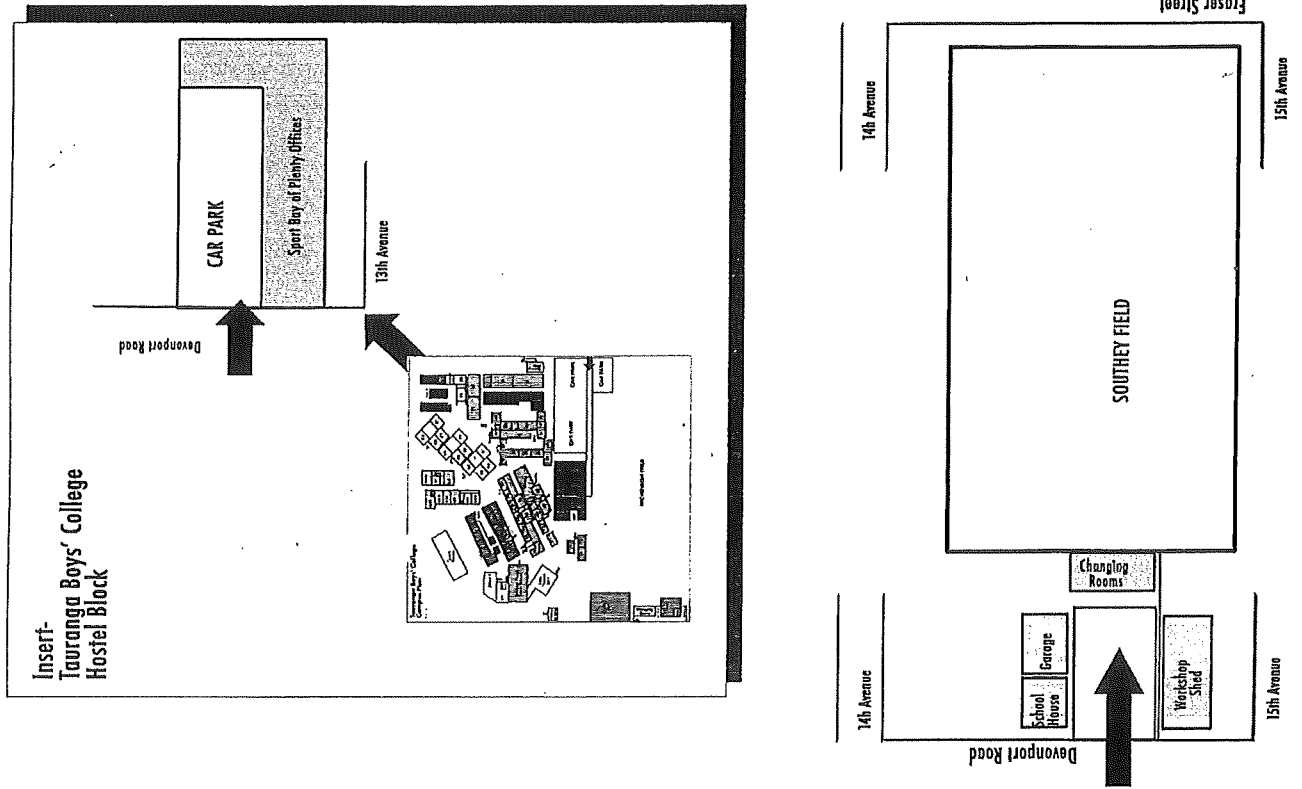

TAURANGA BOYS' COLLEGE

FIRE DRILL

On Discovering a Fire, Notify the Site Warden Immediately

Classroom Notice

Room:

On hearing the Fire Alarm (Continuous ringing of the bell) Students **MUST**, under class Teacher's instructions:

1. LEAVE THE CLASSROOM AND BUILDING BY THE NEAREST EXIT, AS INDICATED BELOW.
2. ASSEMBLE IN ASSEMBLY AREA, AS INCICATED BELOW.
3. **DO NOT** RUN AND **DO NOT** CARRY BAGS OR BOOKS.

STAY IN CLASS GROUPS FOR ROLL CHECK WITH THE CLASS TEACHER, AND REMAIN UNTIL DISMISSED.

THE FIRE EXIT AND ASSEMBLY AREA FOR THIS ROOM IS:

CLASS TEACHERS (Wardens):

Responsible for all students in your care, please take your paper roll with you during evacuation procedures.

1. Check that **ALL** students have left the room.
2. Close **ALL** doors behind you.
3. As you leave, check any adjacent rooms or toilets.
4. Accompany your class **to the designated** assembly area.

On arrival, check immediately that all students are present and give Assistant Site Warden the relevant information.

**** EARTHQUAKE DRILL ****

WHEN AN EARTHQUAKE STRIKES,
STUDENTS AND STAFF SHOULD IMMEDIATELY:

DROP - COVER - HOLD

WHEN BELL RINGS CONTINUOUSLY EVACUATE AS FOR FIRE DRILL
(in the case of power failure siren or hand bell continuously ringing)

NEAREST FIRE ALARM LOCATED:

FIRE HOSE REEL LOCATED:

FIRE EXTINGUISHER LOCATED:

Parking Areas

